

TASMAN COUNCIL
1713 Main Road, Nubeena TAS 7184
Phone: (03) 6250 9200 Facsimile: (03) 6250 9220
Email: tasman@tasman.tas.gov.au
Website: www.tasman.tas.gov.au
ABN: 63 590 070 717

NOTICE OF PROPOSED DEVELOPMENT

Tasman Interim Planning Scheme 2015

Notice is hereby given that an application has been made for planning approval under the Land Use Planning and Approvals Act 1993, for the following development(s):

NUMBER:	DA 59/2019
ADDRESS:	142 Sloping Main Drive, Sloping Main (CT 89648/4)
DESCRIPTION:	Carport

The relevant plans and documents can be inspected at the Council Offices at 1713 Main Road, Nubeena during normal office hours, or the plans may be viewed on Council's website - www.tasman.tas.gov.au until 4:30pm **23rd September 2019**.

Any person may make a representation relating to the application. Representations are to be made in writing addressed to the General Manager, Tasman Council, 1713 Main Road, Nubeena TAS 7184 or by email to tasman@tasman.tas.gov.au and will be received no later than 4.30pm on **23rd September 2019**. Late representations will not be considered.

Kim Hossack
Acting General Manager
Date: 7th September 2019



"A Natural Escape"

Title:

DA 59/2019-Carport-142 Sloping Main Drive, Sloping Main (Ct 89648/4)- The relevant plans and documents can be inspected at the Council Offices at 1713 Main Road, Nubeena during normal office hours, or the plans may be viewed on Council's website at www.tasman.tas.gov.au. until 4:30 on 23rd September 2019

A4

Map



Disclaimer:

This map is a representation of the information currently held by Tasman Council. While every effort has been made to ensure the accuracy of the product, Tasman Council accepts no responsibility for any errors or omissions. Any feedback on omissions or errors would be appreciated.

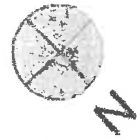

SITE AREA
320 m²

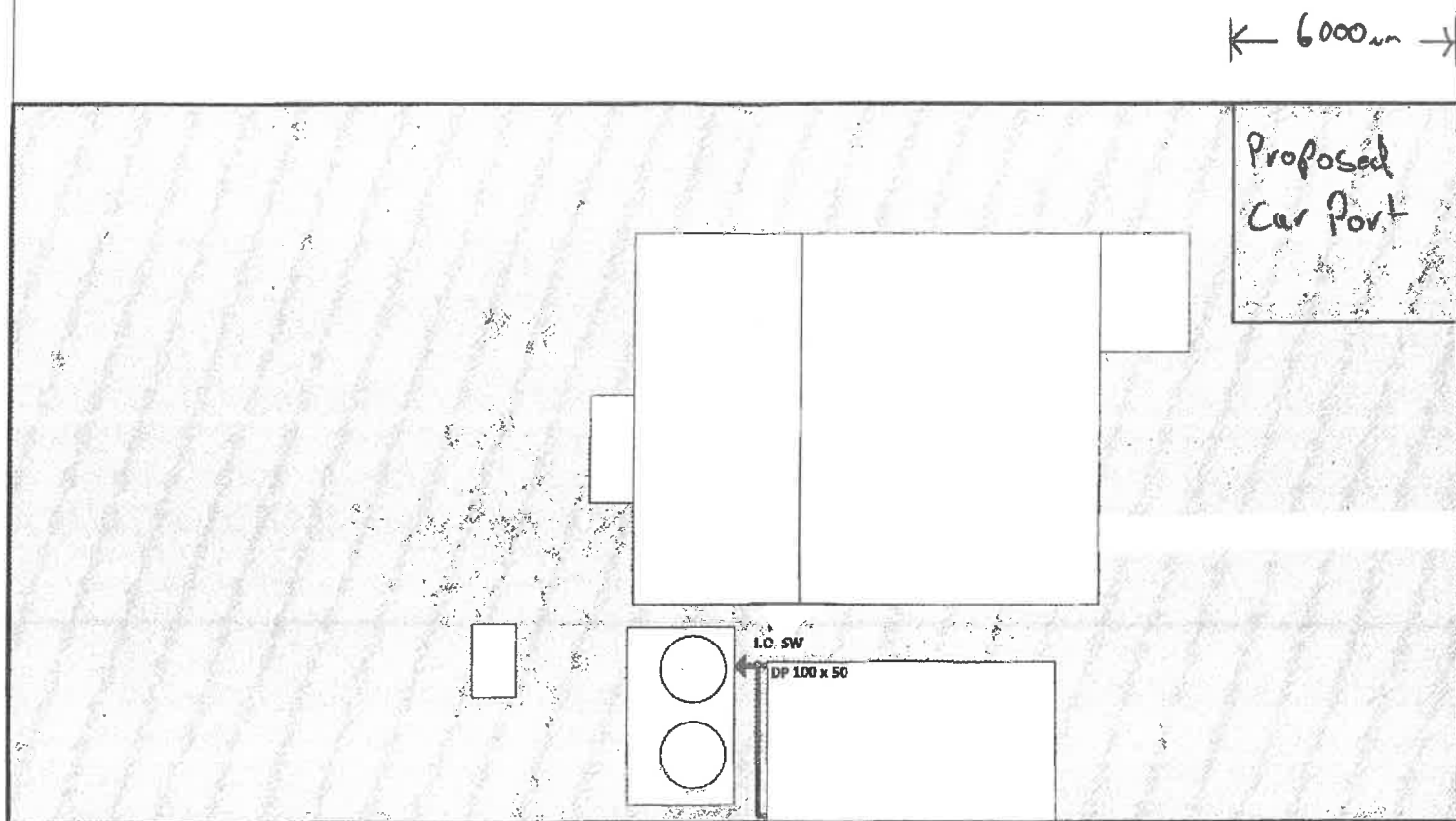

DRAWN: 30/6/19
SCALE: 1:200
REVISED:
CERT:

PROPOSED PETER GEOFFREY WILLIAMS - Car Port
142 SLOPING MAIN DRIVE,
SLOPING MAIN, TASMANIA 7020

PETER GEOFFREY WILLIAMS

DRAWING:

APPLICATION

SHEET:

DATE: 30/6/19

JOB:

A3

30 June 2019

Proposed Car Port 142 Sloping Main Drive Peter Williams

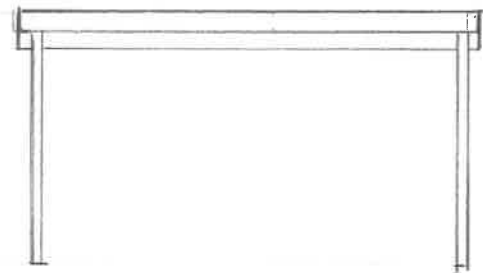

← 6000 mm →

Elevation

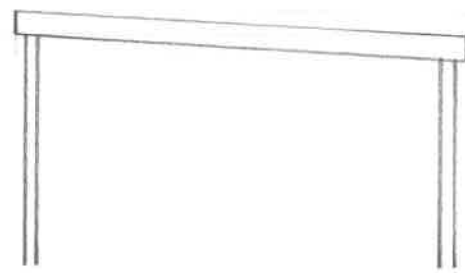

← 6000 mm →

Front Elevation

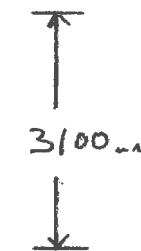
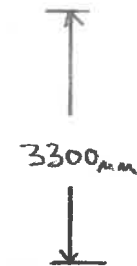

Scale 1 - 100